



“HOUSE 1+1”

“House 1+1” is completely in the factory made wooden living house. The house is supplied to customers completely finished and equipped with kitchen, bathroom and household appliances according to the client's request.

The house to customers is delivered on the transport platform completely finished and packed. Installation of the house on the customer's site - 1 day (for one module house), 3 days (for 2 module house).



“1+1” Single module



“1+1” 40 m2



“1+1” 80 m2

SPECIFICATION

Construction

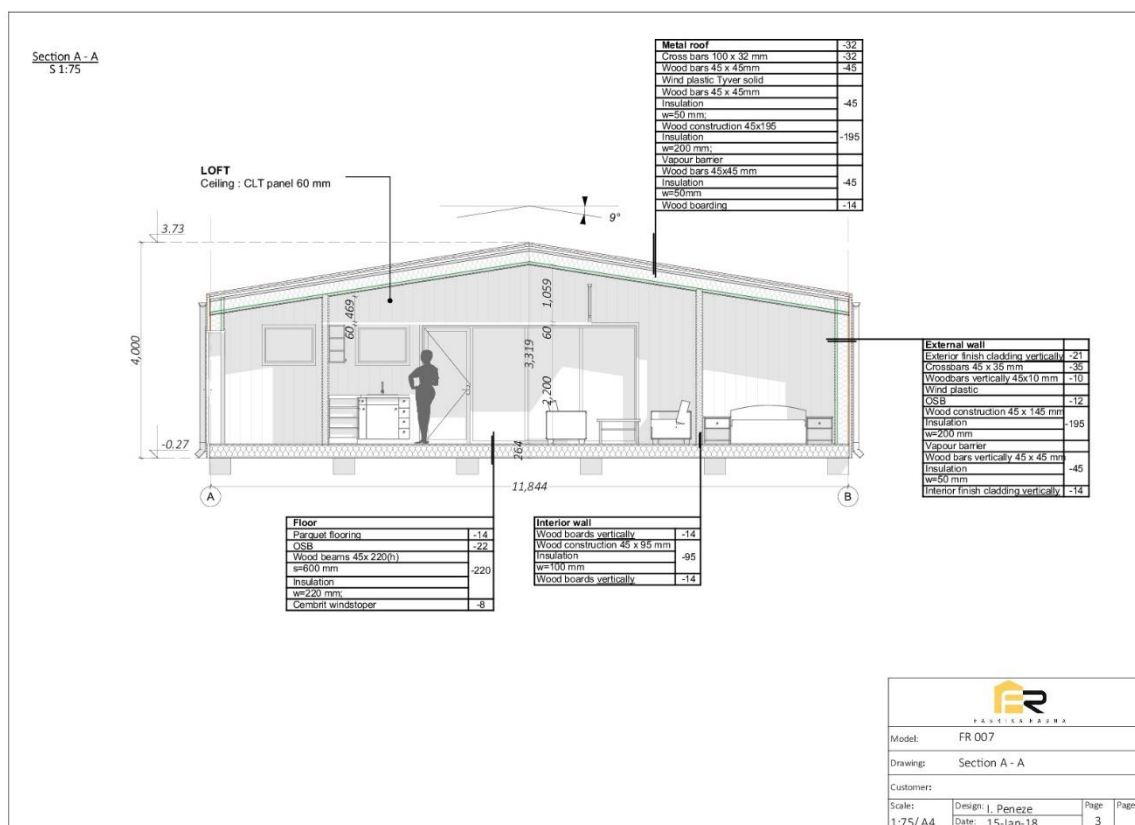

Finishing

Outside panel – vertical direction, fine sawed or planed spruce, 21x80-145 mm board, painted (Teknos, Tikkurila)

Inside panel –

- horizontal direction board, fine sawed or planed pine, 14x80x145 mm board, painted with water based paint (Remmers, Adler)
- Hunton veggpanel (<https://www.huntonit.no/veggplater/>)

Floor - Tarkett oak parquet (<https://www.tarkett.com/>)

*pine boards or tiles optional

Doors and windows

Scandinavian profile wooden doors and windows triple glazed glass

Inside doors – oak doors with or without glass, natural brown or painted white

Roofing

Ruukki Classic C 50+ metal roof

*other covers is an optional

Water supply and sewerage

Fully finished external connections. Incoming water pipe with warm cable (Uponor Ecoflex Supra PLUS), prevents pipe from freezing,

Suppliers - Uponor, LK systems, Oras, Purus, Grohe, Ifö, Franke

Electrical installation

Suppliers - Schneider electric, ABB, Draka, Devi

Lightning:

- 3 LED outside lights
- LED inside lights with dimmer function in living area and bedroom

Heating

Electric oil filled radiators

*electric heated floors (Devi) or heating pump (Nibe, Panasonic) optional

Bathroom

1. MIRA System 2 - flexible waterproofing for wet rooms.
2. Floors- floor heating, covered with tiles (33x33).
3. Walls:
 - Tiles 15x30
 - Fibo Trespo wall panels (<http://fibo-trespo.com>)
4. Plumbing:
 - Toilet – Ifo Sign
 - Bathroom tap - Grohe Bauloop
 - Shower system – Grohe Euphoria System 180
5. Bathroom furniture:
 - bathroom sink cabinet (<http://www.kame.lt/en>)
 - mirror cabinet
6. Equipment:
 - shower wall
 - towel dryer
7. Appliances:
 - washing machine - Electrolux with or without dryer

Kitchen

Custom made kitchen, 3,4 m, materials from EGGER.

*other kitchen countertop materials (massive wood, MEGANITE <http://korte.lv/en/meganite/>) optional

Kitchen appliances (Electrolux, AEG):

- Fridge – 175cm free standing or built in
- Oven
- Dishwasher
- Cook top with 4 rings, induction
- Cooker hood

**House finishing materials and equipment is agreed with the client before the start of production.*